

SPECIFICATIONS:

MATERIALS:
 BACKSHELL: THERMOPLASTIC
 ALIGNMENT SLEEVE: TIN PLATED STEEL
 COVER: TIN PLATED STEEL
 INSULATOR (MATING END): THERMOPLASTIC
 INSULATOR (REAR END): THERMOPLASTIC
 #2-56 THUMBSCREW: NICKEL PLATED STEEL

ELECTRICAL:
 RATED CURRENT: 1A
 D.W.V.: 500V for 1min

ENVIRONMENT:
 OPERATING TEMPERATURE: -10°C TO +70°C

MATING CYCLES: 300
 MAXIMUM DISCRETE WIRE JACKET OD: 0.039"

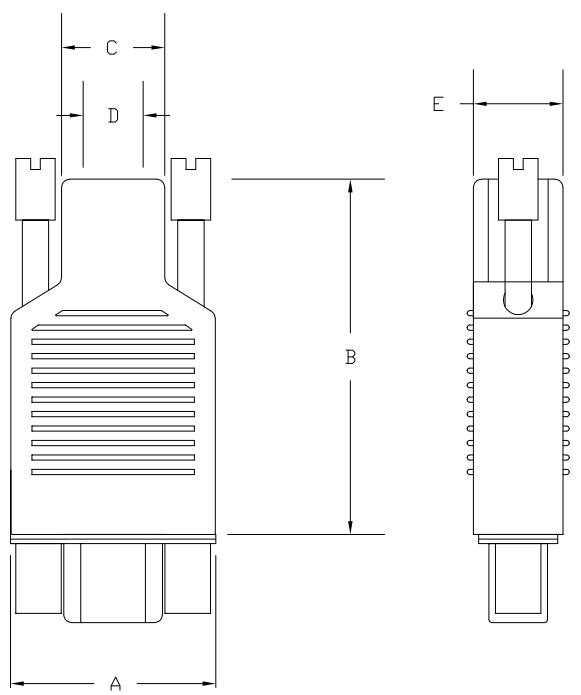

		DIMENSIONS				
No. OF PINS	UNITS	A	B	C	D MAX	E
9	inch	0.780	1.350	0.395	0.228	0.338
	mm	19.81	34.29	10.03	5.79	8.59
15	inch	0.932	1.367	0.360	0.284	0.338
	mm	23.67	34.72	9.14	7.21	8.59
25	inch	1.195	1.373	0.390	0.331	0.390
	mm	30.35	34.87	9.91	8.41	9.91

BACKSHELL KIT INCLUDES:

- 1x - BACKSHELL
- 1x - ALIGNMENT SLEEVE
- 1x - COVER
- 1x - INSULATOR (MATING END)
- 1x - INSULATOR (REAR END)
- 2x - #2-56 THUMBSCREW

MATING CONNECTORS:
 DESIGNED TO MATE WITH MICRO D CONNECTORS USING TRADITIONAL SPRING/TWIST PIN NESTED CONTACTS.
 NORCOMP MATES BELOW:
 380-YYY-113L001 (YYY = REPLACE WITH CIRCUIT COUNT)
 381-YYY-112L565 (YYY = REPLACE WITH CIRCUIT COUNT)

NOTE #1:
 CONTACTS MUST BE PURCHASED SEPARATELY (part numbers below):
 960-001-170L005 (reeled contacts)
 960-101-170L005 (loose contacts)
 960-702-170-00 (crimp tool)

NOTE #2:
 NOT DESIGNED TO MATE WITH NORCOMP 580-M // 581-M SERIES CONNECTORS.
 IF ANY QUESTIONS PLEASE CONTACT ENG@NORCOMP.NET

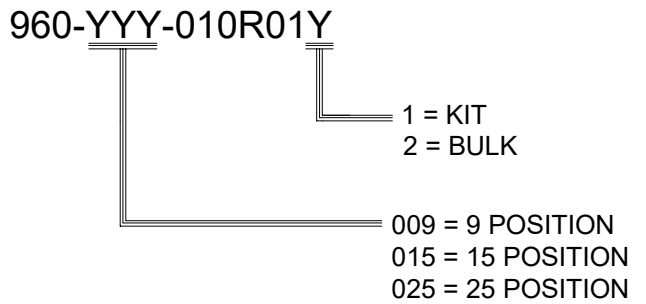

RoHS COMPLIANT

UNITS = "as indicated" DO NOT SCALE FROM DRAWING

	THESE DRAWINGS AND SPECIFICATIONS ARE THE PROPERTY OF NorComp AND SHALL NOT BE REPRODUCED, COPIED OR USED AS THE BASIS FOR THE MANUFACTURE OR SALE OF APPARATUS WITHOUT WRITTEN PERMISSION.	DRAWN: M. SIGMON
		DATE: 09/01/2011

	SCALE: NTS	SHEET OF 1 2	REV 10
	DWG NO. 960-YYY-010R01Y		

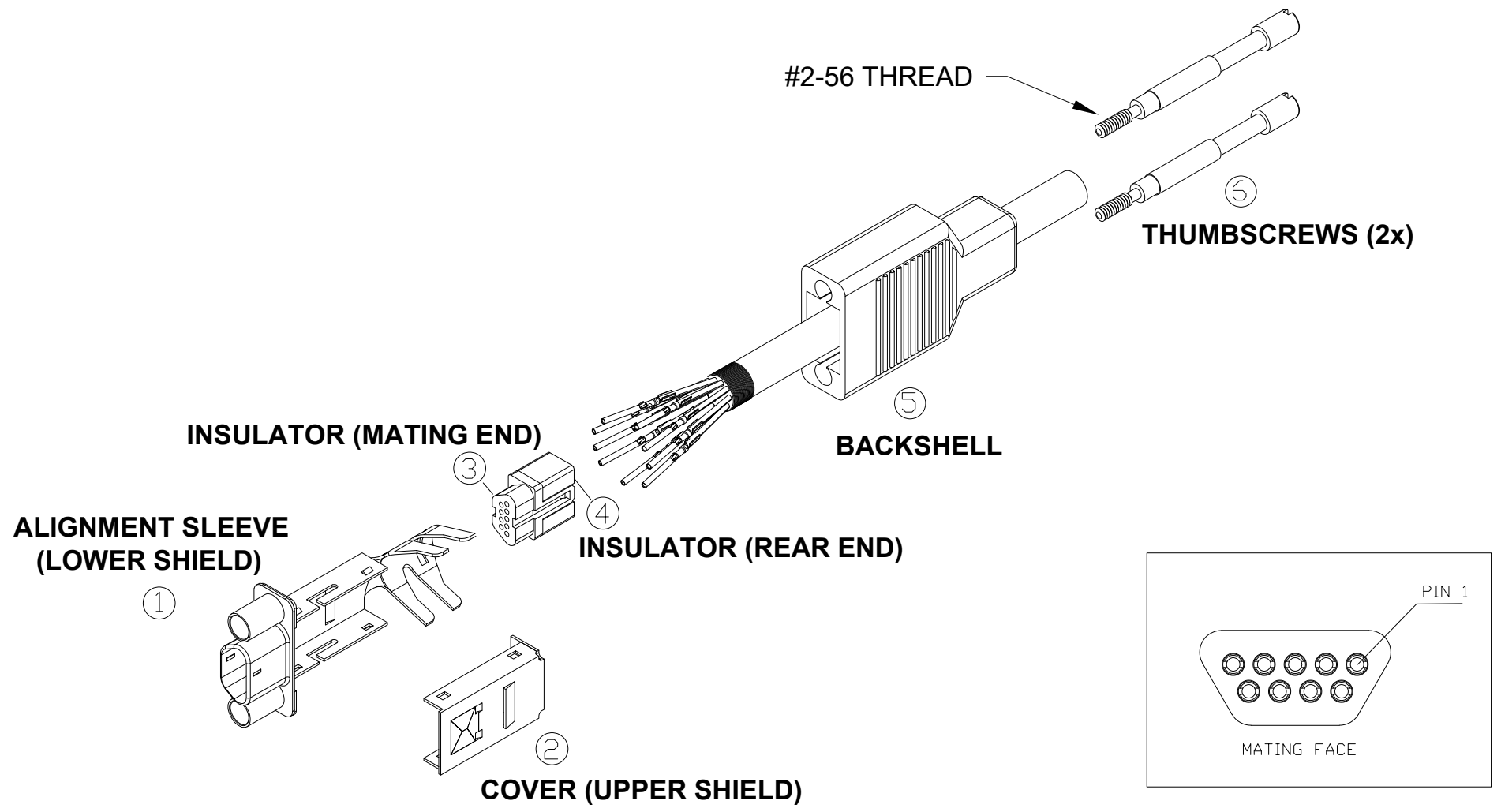

RoHS COMPLIANT

DO NOT SCALE FROM DRAWING



THESE DRAWINGS AND SPECIFICATIONS ARE THE PROPERTY OF NorComp AND SHALL NOT BE REPRODUCED, COPIED OR USED AS THE BASIS FOR THE MANUFACTURE OR SALE OF APPARATUS WITHOUT WRITTEN PERMISSION.

DRAWN:
M. SIGMON
DATE:
09/01/2011

NorComp

SCALE: NTS	SHEET 2	OF 2	REV 10
DWG NO.		960-YYY-010R01Y	