

PCB LAYOUT

MATERIAL:

HOUSING: NYLON 6T, UL 94V-0, BLACK
CONTACT: PHOSPHOR BRONZE
PLATING: GOLD FLASH ENTIRE CONTACT

ELECTRICAL:

CURRENT RATING: 2 AMPS
CONTACT RESISTANCE: 20mOHMS Max.
INSULATOR RESISTANCE: 5,000MOHMS Min.
DIELECTRIC WITHSTANDING: 500VAC
OPERATING TEMPERATURE: -40° TO +105° C
PROCESS TEMPERATURE: 260° C FOR 10 SECONDS

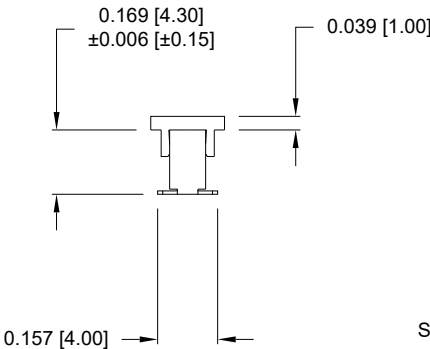

2863 YY 06 R P2 YY

SERIES _____
2863 = SINGLE ROW
POSITIONS _____
SINGLE - INCREMENTS OF 1
(3 TO 40)
TYPE _____
06 = SURFACE MOUNT
RoHS COMPLIANT _____
HIGH TEMP. _____
PLATING _____
P2 = GOLD FLASH
PACKAGING _____
TR = TAPE AND REEL
TC = TUBE PACK WITH PICK AND PLACE CAP

GENERAL TOLERANCE = ±0.008 [±0.20]

RoHS COMPLIANT



THESE DRAWINGS AND SPECIFICATIONS ARE THE PROPERTY OF NorComp AND SHALL NOT BE REPRODUCED, COPIED OR USED AS THE BASIS FOR THE MANUFACTURE OR SALE OF APPARATUS WITHOUT WRITTEN PERMISSION.

DRAWN:
J. KADEL

DATE:
01/11/2019

UNITS = inch[mm]

DO NOT SCALE FROM DRAWING

NorComp

SCALE:
NTS

SHEET 1 OF 1

REV 2

DWG NO.

2863YY06RP2YY