

PANEL CUTOUT

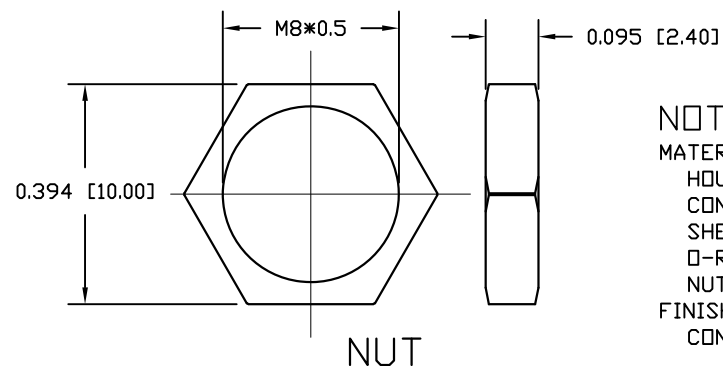

NOTE:

MATERIAL

HOUSING:

CONTACT:

SHELL:

O-RING:

NUT:

FINISH

CONTACT:

PA66 UL94V-0, BLACK

BRASS

STAINLESS STEEL 316

NBR, BLACK

STAINLESS STEEL 316

10u" GOLD PLATED

OVER 50u" NICKEL

ELECTRICAL

RATED CURRENT:

RATED VOLTAGE:

INSULATION RESISTANCE:

CONTACT RESISTANCE:

WATER PROOF:

ENVIRONMENT

OPERATION TEMPERATURE:

1A

30V

100 mOhms MIN.

10 MOhms MAX.

IP67

-40°C TO +105°C

WIRE GAUGE:

24-28 AWG

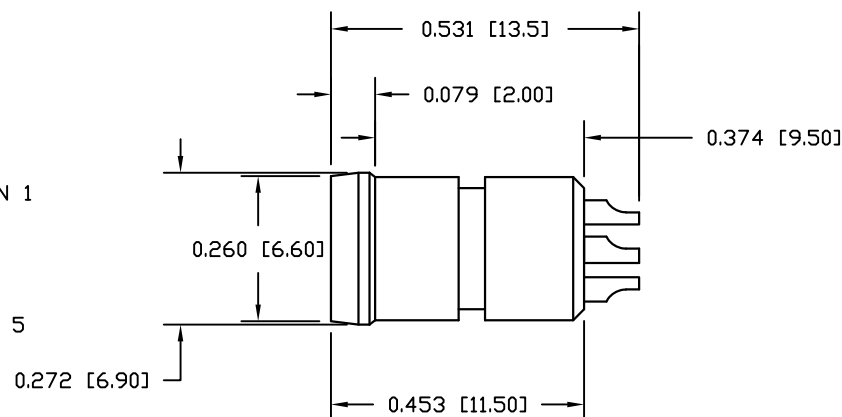
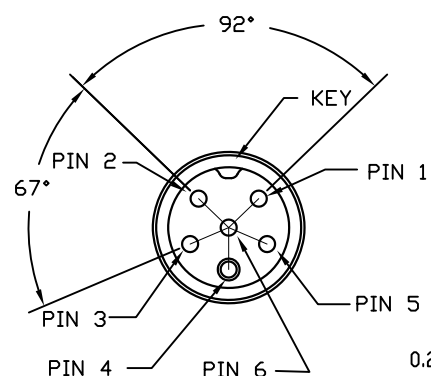
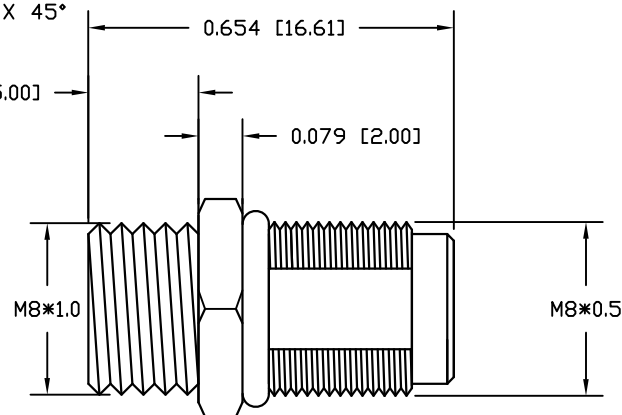
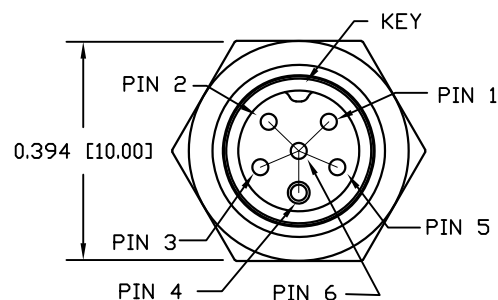

RoHS COMPLIANT

DO NOT SCALE FROM DRAWING



THESE DRAWINGS AND SPECIFICATIONS ARE THE PROPERTY OF NorComp AND SHALL NOT BE REPRODUCED, COPIED OR USED AS THE BASIS FOR THE MANUFACTURE OR SALE OF APPARATUS WITHOUT WRITTEN PERMISSION.

DRAWN:

M. SIGMON

DATE:

05-03-17

CHECKED:

DATE:

NorComp

SCALE:

N.T.S.

SHEET

1

OF

1

REV

6

DWG NO.

855-V06-1SSR004