

DESCRIPTION: M5 FEMALE - CABLE MOUNT - SOLDER CUP - 3 POSITION - SHIELDED

NOTE:

MATERIAL

HOUSING: TPU, BLACK
 SHELL: BRASS
 CONTACT: PHOSPHOR BRONZE
 NUT: BRASS
 O-RING: NBR, BLACK

FINISH

SHELL: TIN PLATED
 CONTACT: GOLD PLATED
 OVER 50μ NICKEL
 NICKEL PLATED

ELECTRICAL

RATED CURRENT: 1A
 RATED VOLTAGE: 60V
 INSULATION RESISTANCE: 100 mΩhms MIN.
 CONTACT RESISTANCE: 10 mΩhms MAX.
 WATER PROOF: IP67

ENVIRONMENT

OPERATION TEMPERATURE: -40°C TO +85°C
 WIRE GAUGE: 26-28 AWG

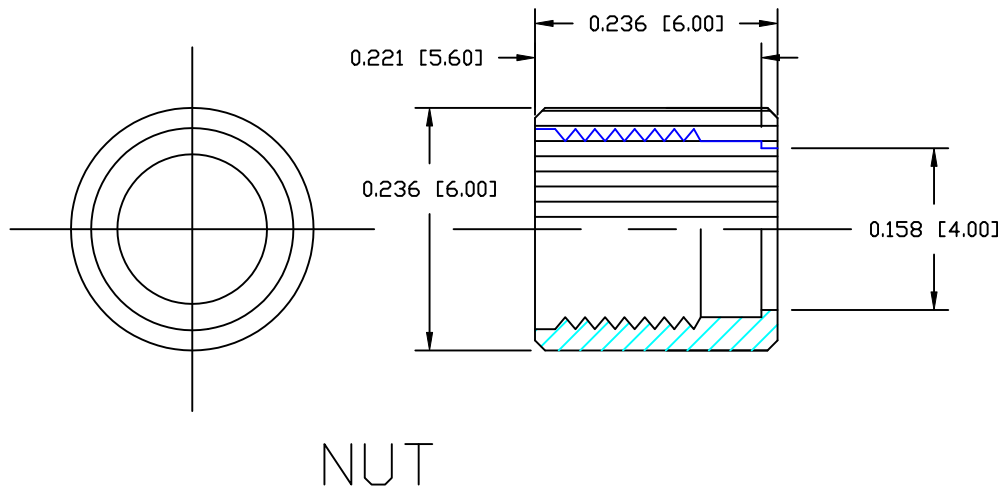
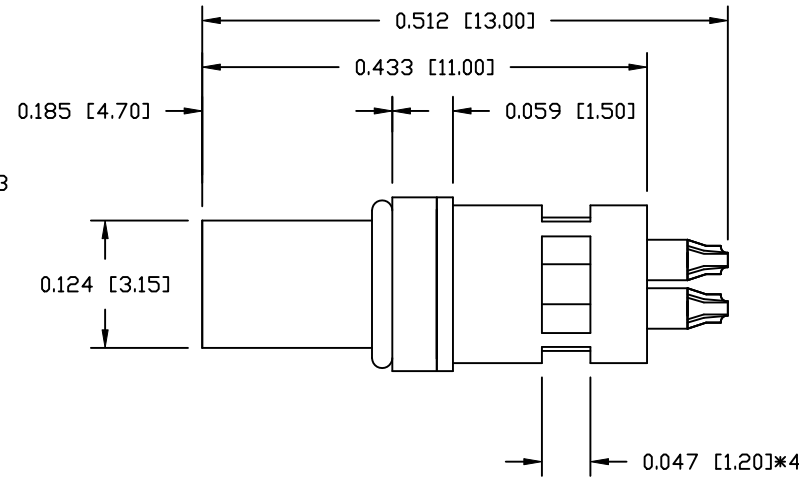
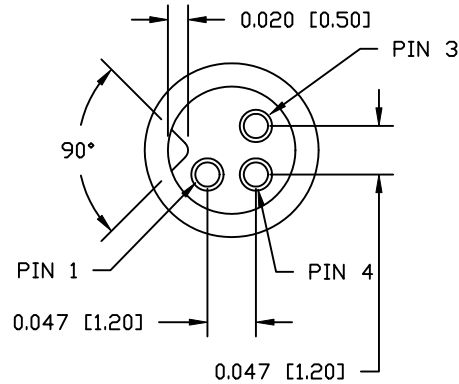

850-003-203RSSY

1 = GOLD FLASH
 4 = 10μ" GOLD

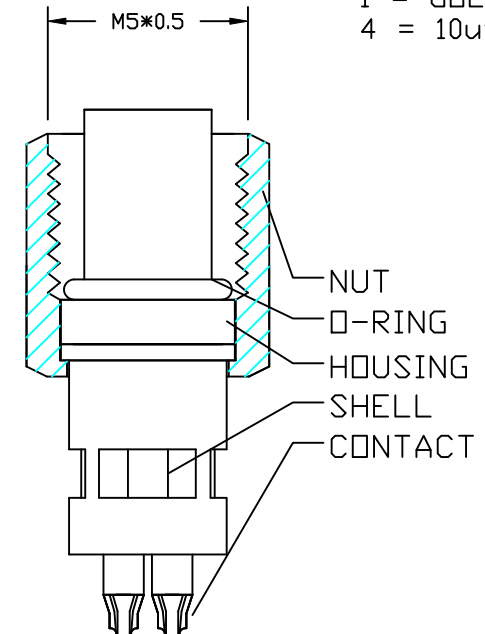

RoHS COMPLIANT

DO NOT SCALE FROM DRAWING



THESE DRAWINGS AND SPECIFICATIONS ARE THE PROPERTY OF NorComp AND SHALL NOT BE REPRODUCED, COPIED OR USED AS THE BASIS FOR THE MANUFACTURE OR SALE OF APPARATUS WITHOUT WRITTEN PERMISSION.

DRAWN:

M. SIGMON

DATE:

03-03-16

CHECKED:

DATE:

NorComp

SCALE:

NTS

SHEET

1

OF

1

REV

1

DWG NO.

850-003-203RSSY