

TORQUE SETTING

6.1-9.5 in-lbs [7-11 kgf-cm]

MATERIAL & FINISH

BACKSHELL: ABS - UL HB RATED - BLACK  
BUSHING & BAFFLE: SILICONE  
THUMBSCREWS: NICKEL PLATED BRASS  
OPERATION TEMPERATURE: 0°C TO 80°C (BASED ON ABS)

NOTES:

MAXIMUM CABLE DIAMETER: Ø9.8mm

MATING PARAMETERS:

RECOMMENDED MAX TORQUE: 40 in-oz  
NOMINAL GASKET COMPRESSION: 0.055"

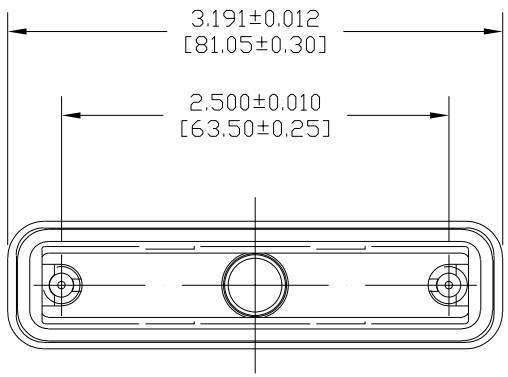

RoHS COMPLIANT



THESE DRAWINGS AND SPECIFICATIONS ARE THE PROPERTY OF NorComp AND SHALL NOT BE REPRODUCED, COPIED OR USED AS THE BASIS FOR THE MANUFACTURE OR SALE OF APPARATUS WITHOUT WRITTEN PERMISSION.

DRAWN:  
J. KADEL

DATE:  
08/23/2021

UNITS = inch [mm]

DO NOT SCALE FROM DRAWING

NorComp

SCALE:  
NTS

SHEET 1 OF 1

REV 2

DWG NO. 967-037-010R011