

DESCRIPTION: QUICK RELEASE - DIE CAST

**SPECIFICATIONS:**

MATERIAL: ZINC ALLOY, ZAMAK Z0410  
TEMP RATING: -40°C to +90°C

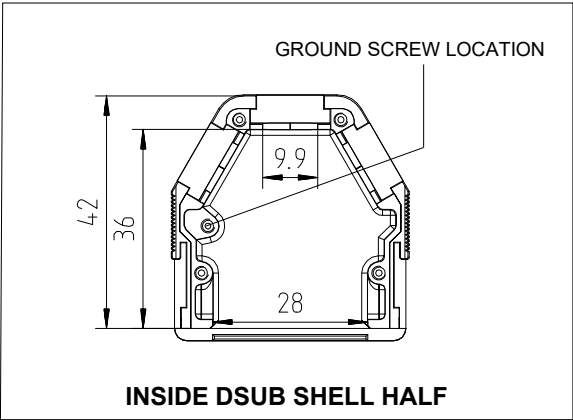
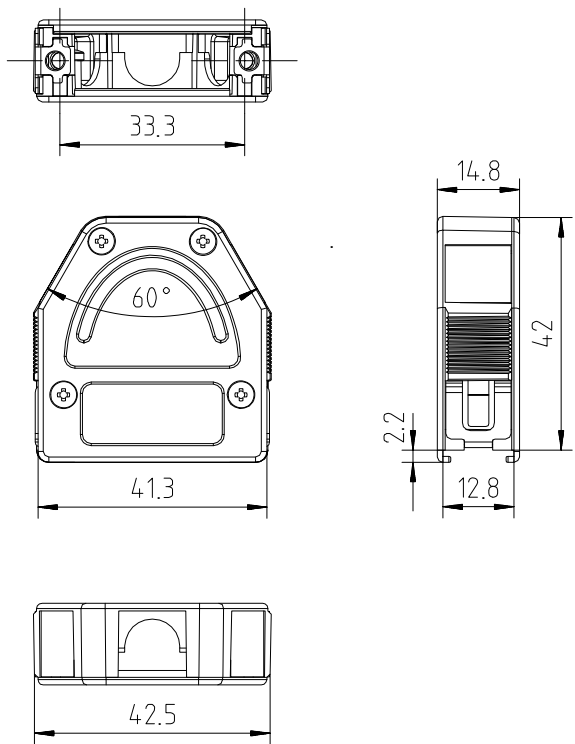

**BACKSHELL KIT INCLUDES:**

- (2) BACKSHELL HALVES
- (4) MOUNTING SCREWS // M2.5
- (1) GROUNDING SCREW // M2.5
- (2) BLIND PLATE/PLUG

**955-015-030R121**

SERIES \_\_\_\_\_  
POSITIONS \_\_\_\_\_  
015 \_\_\_\_\_  
MATERIAL \_\_\_\_\_  
030 = DIE CAST  
COLOR \_\_\_\_\_  
12 = METAL(IZED)  
PUT-UP \_\_\_\_\_  
1 = KIT

**ADDITIONAL CABLE CLAMP ORDERED SEPARATELY  
SEE NORCOMP PRODUCT PAGE - PART #955-15-SR-7-10**

**RoHS COMPLIANT**



THESE DRAWINGS AND SPECIFICATIONS ARE THE PROPERTY OF NorComp AND SHALL NOT BE REPRODUCED, COPIED OR USED AS THE BASIS FOR THE MANUFACTURE OR SALE OF APPARATUS WITHOUT WRITTEN PERMISSION.

DRAWN:  
J. F. KADEL  
DATE:  
11/14/2022

UNITS = mm

**DO NOT SCALE FROM DRAWING**

**NorComp**

SCALE: NTS  
SHEET 1 OF 1  
REV 0  
DWG NO. 955-015-030R121