



A DIVISION OF EDAC (AMERICA) LIMITED

3300 Int'l Airport Dr., Ste. 200, Charlotte, NC 28208 (704) 424-5448 Fax: (704) 424-5648 www.norcomp.net

(Product Change Notification)

Wednesday, March 25, 2015

PCN# 030115

To Whom It May Concern:

Please be advised NorComp has made a change to item numbers listed on the next page. Our records show that you have purchased some of these products in the last 5 years. Updated drawings are located on page 3 & 4 of this PCN and on the NorComp web site at www.norcomp.net.

Change Description: In order to provide consistent colors in our 972 series hoods/backshells, Norcomp has established "Pantone Color Numbers" for this series. We will begin shipping the new "Pantone Colors" over the next 3 months.

We appreciate your understanding as we strive to offer you the most current information regarding our product.

Please confirm receipt & acceptance of product change notification (by returning signed copy by fax or email) and contact us if you need any additional assistance.

Regards,
Matt Sigmon
Product Engineer
Fax: 704-424-5648

Approved By: _____

Company: _____

Title: _____

Date: _____

972-009-01SR011
972-015-01SR011
972-025-01SR011
972-037-01SR011

972-009-01SR031
972-015-01SR031
972-025-01SR031
972-037-01SR031

972-009-01SR041
972-015-01SR041
972-025-01SR041
972-037-01SR041

972-009-01SR061
972-015-01SR061
972-025-01SR061
972-037-01SR061

972-009-01SR071
972-015-01SR071
972-025-01SR071
972-037-01SR071

972-009-01SR081
972-015-01SR081
972-025-01SR081
972-037-01SR081

972-009-01SR111
972-015-01SR111
972-025-01SR111
972-037-01SR111

DESCRIPTION: 972 SERIES D-SUB SLIM-LINE BACKSHELL

BACKSHELL KIT INCLUDES:

- (1) BACKSHELL
- (2) 4-40 THUMBSCREWS
- (1) PLASTIC STRAIN RELIEF
- (1) METAL STRAIN RELIEF CLAMP
- (2) STRAIN RELIEF SCREWS

TORQUE VALUE ON PLASTIC FOR STRAIN RELIEF SCREWS = 4 INCH POUNDS MAX.

972-YYY-01SRYYY1

SERIES _____
 POSITIONS _____
 009
 015
 025
 037
 MATERIAL _____
 01S = PLASTIC/SLIM LINE
 COLOR: _____
 01 = BLACK
 03 = LIGHT GREY
 04 = GREEN
 06 = RED
 07 = BLUE
 08 = YELLOW
 11 = DEC GREY
 PUT-UPS _____
 1 = KIT

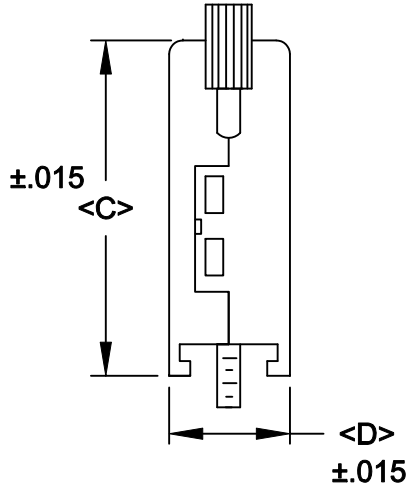
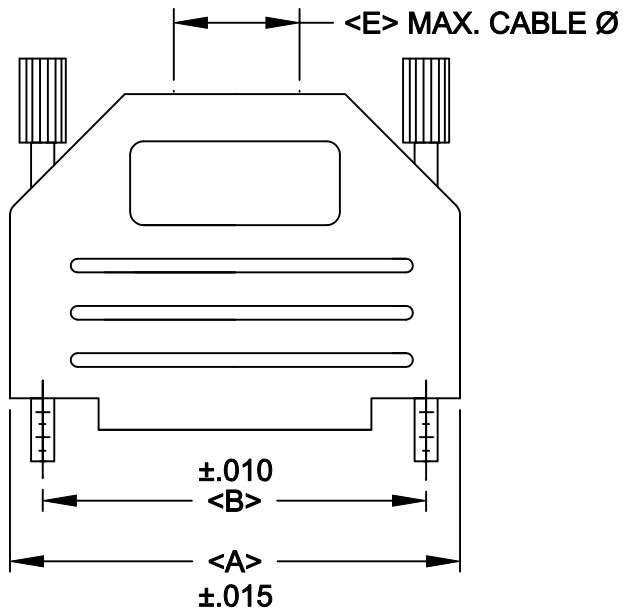

****SEE PAGE 2 FOR PANTONE COLOR CODES**

POS.	A	B	C	D	E
9	1.240	.984	1.339	.591	.315
	31.50	24.99	34.00	15.00	8.00
15	1.575	1.312	1.339	.591	.453
	40.00	33.32	34.00	15.00	11.50
25	2.106	1.852	1.575	.591	.453
	53.50	47.04	40.00	15.00	11.50
37	2.795	2.500	1.575	.591	.453
	71.00	63.50	40.00	15.00	11.50

MATERIAL: POLYAMIDE PA66 - UL 94H-B
MANY COLORS AVAILABLE

THUMBSCREWS: STEEL

OPERATING TEMP: -30°C TO +110°C
RoHS COMPLIANT

	THESE DRAWINGS AND SPECIFICATIONS ARE THE PROPERTY OF NorComp AND SHALL NOT BE REPRODUCED, COPIED OR USED AS THE BASIS FOR THE MANUFACTURE OF SALE OF APPARATUS WITHOUT WRITTEN PERMISSION.		DRAWN: PAM JENKINS	DATE: 6-10-05
			CHECKED:	DATE:
<h1>NorComp</h1>	SCALE:	SHEET 1 OF 2	REV 5	
	DWG NO. 972-YYY-01SRYYY1			

COLOR RANGE		
COLOR	UPPER	LOWER
01 = BLACK	PANTONE BLACK 3C	PANTONE BLACK 3C
03 = LIGHT GREY	427C	427C
04 = GREEN	7731C	7732C
06 = RED	186C	187C
07 = BLUE	2190C	2191C
08 = YELLOW	108C	109C
11 = DEC GREY	7527C	7534C



THESE DRAWINGS AND SPECIFICATIONS ARE THE PROPERTY OF NorComp AND SHALL NOT BE REPRODUCED, COPIED OR USED AS THE BASIS FOR THE MANUFACTURE OF SALE OF APPARATUS WITHOUT WRITTEN PERMISSION.

DRAWN:

PAM JENKINS

DATE:

6-10-05

CHECKED:

DATE:

SCALE:

SHEET

OF

2

2

REV

5

DWG NO.

972-YYY-01SRYY1

NorComp